



DELTA ENVIRONMENTAL[®]
D2C20-21 SERIES
SUBMERSIBLE GRINDER PUMP



DELTA ENVIRONMENTAL® D2C20-21 SERIES Submersible Grinder Pump

The Changing Force in Pressure Sewer

The reliable D2C20-21 2 hp submersible grinder pump offering by Delta Environmental is designed specifically for use in pressure sewer applications with long discharge runs or high static heads. It features an innovative hardened cutter mechanism and recessed impeller design to effectively macerate typical domestic sewage solids into a fine slurry. As the world evolves from concrete septic tanks and large piping gravity collection systems to more innovative wastewater solutions, the use of submersible grinder pumps in Low Pressure Sewer (LPS) systems for the residential developer applications has proven to be a superior Delta Environmental solution that is cost effective and minimally disruptive to the natural environment. The D2C20-21 Series can be installed in a variety of packaged systems. Factory-assembled simplex or duplex packages with guide rail systems or free-standing systems are available. Delta Environmental also has complete turn-key systems to make selection simple. Individual rail components are also available for installation in on-site concrete systems. For additional information, please contact your local Delta Environmental representative.

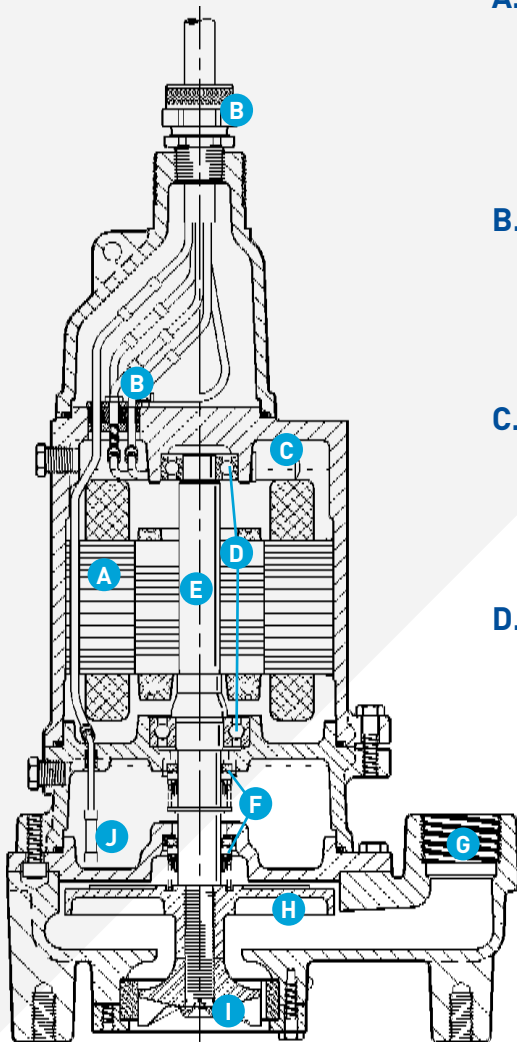

A. Powerful Motor

2 hp, 3450 RPM, 1 phase. Press fit for perfect alignment and best heat transfer. Oil-filled motor conducts heat and lubricates bearings. Class F VFD/continuous duty rated.

B. Cable Entry System

Provides double seal protection. Cable jacket sealed by compression fitting. Individual wires sealed by compression grommet. Power cord can be replaced without disturbing motor.

C. Overload-Heat Sensor

(1 phase only) Protects motor from burn-out due to excessive heat from any overload condition. Automatically resets when motor has cooled.

D. Ball Bearings

Upper and lower ball bearings support shaft and rotor and take axial and radial loads.

E. Heavy 416 Sst Shaft

Corrosion resistant. Reduces shaft deflection due to grinding loads.

F. Shaft Seals

Double tandem mechanical shaft seals protect motor. Oil-filled seal chamber provides continuous lubrication.

G. Volute Case

Cast iron 1-1/4" NPT vertical flanged discharge.

H. Impeller

Cast iron recessed impeller handles ground slurry without clogging or binding. Provides unobstructed flow passage. Reduces radial loads. Pump-out vanes help keep trash from seal, reduces pressure at seal faces.

I. Grinder Assembly

Grinder impeller and shredding ring are replaceable without dismantling pump. Constructed of 440 SST hardened to 56 – 60 Rockwell.

J. Seal Leak Probe (Opt.)

Detects water in seal housing, activates warning light in control panel.

The Future of On-site Wastewater – Available Today

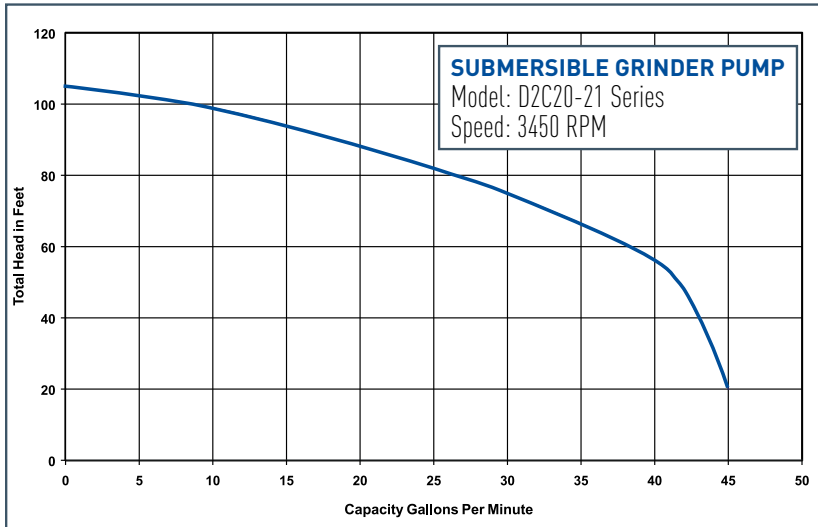

| Construction Materials | |
|--|--|
| Motor housing, seal volute case, recessed impeller | Cast iron, Class 30, ASTM A48 |
| Power cord | w/seal probe 20' 14/5 SOOW w/o seal probe 20' 14/4 SOOW |
| Mechanical seals | Double tandem carbon & ceramic |
| Pump, motor shaft | 416 SST |
| Fasteners | 300 Series SST |
| Shredding ring, grinder impeller | 440 SST, 58 – 60 Rockwell |

| Pump Capabilities | | |
|------------------------------------|--|----------------|
| Liquids handling | Domestic raw sewage | |
| Intermittent liquid temp. | up to 140°F up to 60°C | |
| Winding insulation temp. (Class F) | 311°F 155°C | |
| Motor electrical data | 2 HP, 3450 RPM 1 ph – capacitor start/run. 230 volt; 60 Hz | |
| Third party approvals* | CSA, UL, cUL | |
| Acceptable pH range | 6 – 9 | |
| Specific gravity | .9 – 1.1 | |
| Viscosity | 28 – 35 SSU | |
| Discharge, NPT | 1-1/4 in. | |
| Min. sump diameter | Simplex | 24 in. 61.0 cm |
| | Duplex | 36 in. 91.4 cm |

| Motor Electrical Data | | | | | | | | | | | |
|-----------------------|----|-------|-------|-------|------------|----------|--------|-----------|---------|-----------------|----------------|
| Model | HP | Volts | Phase | Hertz | Start Amps | Run Amps | Run KW | Start KVA | Run KVA | NEC Code Letter | Service Factor |
| D2C20-21 | 2 | 230 | 1 | 60 | 44.0 | 12.0 | 2.8 | 10.1 | 2.8 | F | 1.25 |

Pump Nameplate

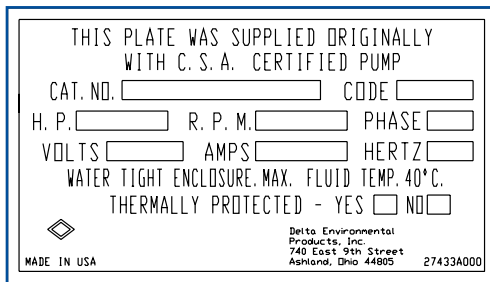

Pump Dimensions

[Dimensions in MM]

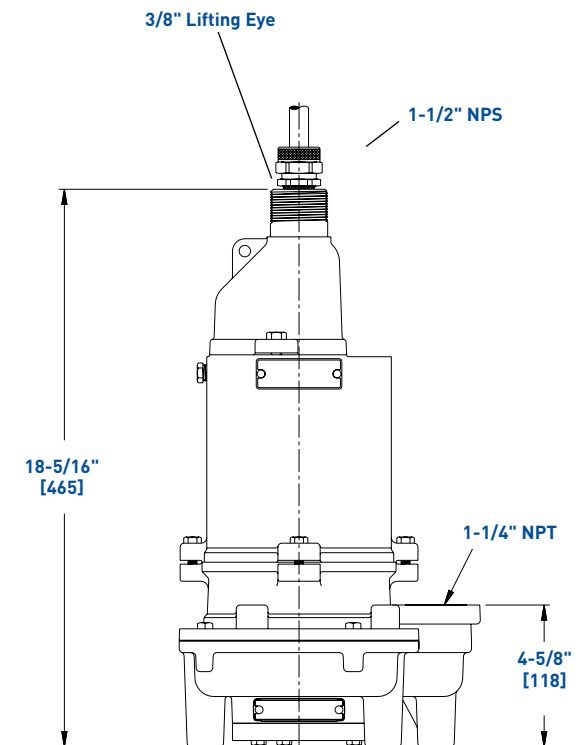
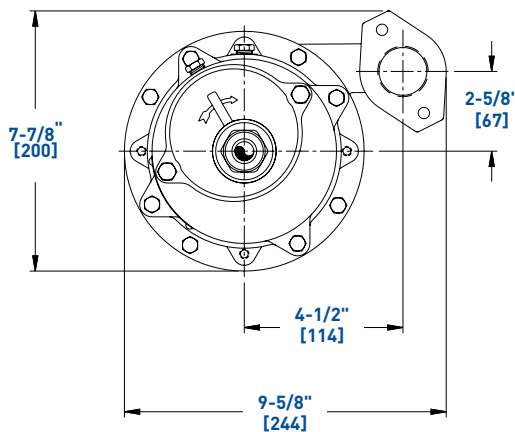

Note: Consult factory for applications outside of these recommendations.

* Models with third party approval(s) are clearly marked on individual pump nameplates.

Installation Details

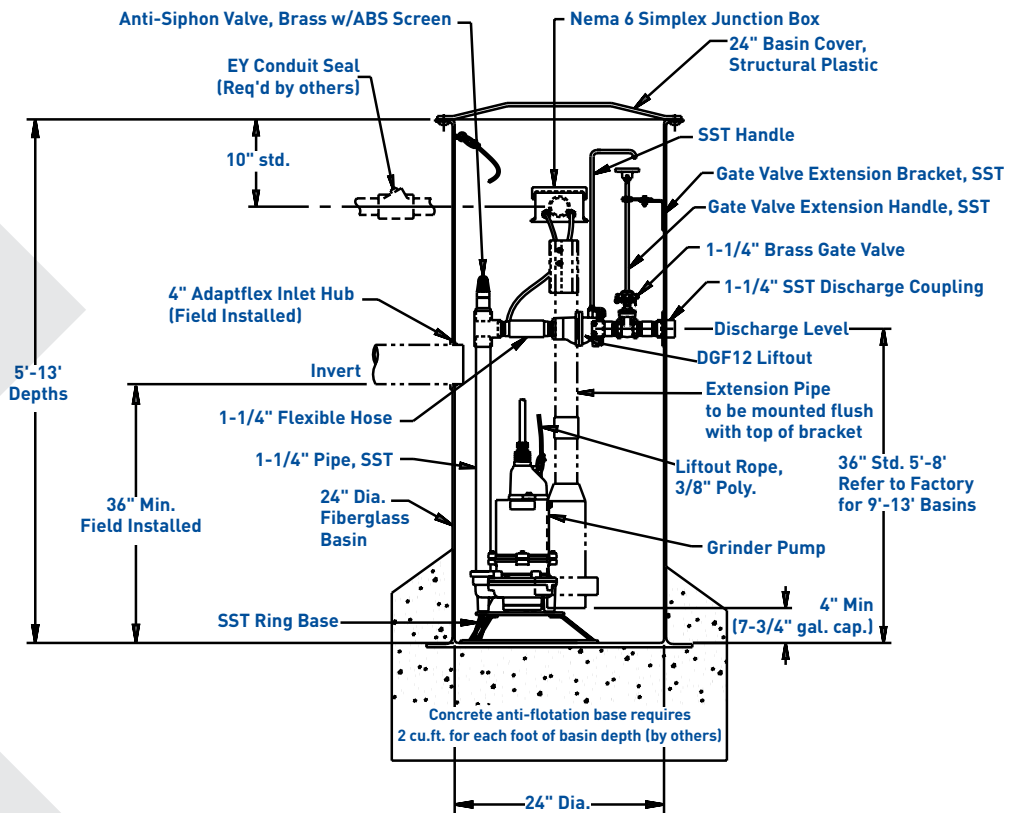
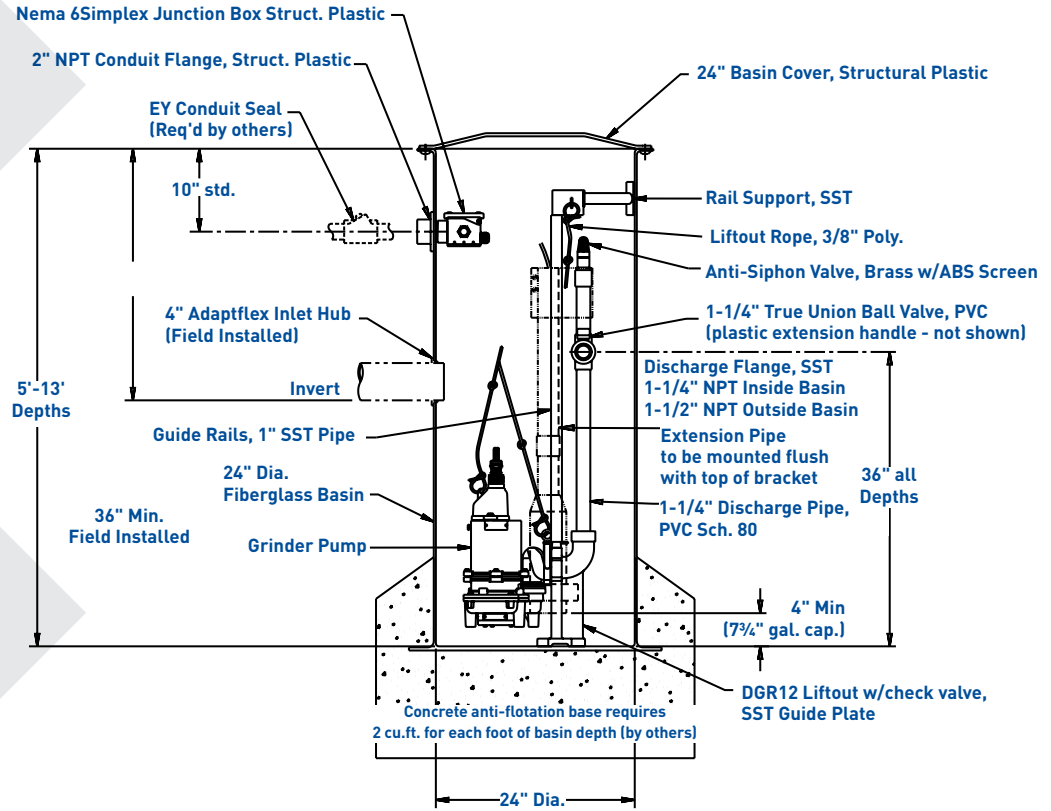

8263 FLORIDA BLVD., DENHAM SPRINGS, LA 70727, 225-665-6162, 1 (800) 219-9183 | WWW.DELTAENVIRONMENTAL.COM

Because we are continuously improving our products and services, Pentair reserves the right to change specifications without prior notice.
K4269 07/28/13 © 2013 Pentair Ltd. All Rights Reserved.