



DELTA ENVIRONMENTAL[®]
D2CX20-21 SERIES
SUBMERSIBLE CENTRIFUGAL
GRINDER PUMP



DELTA ENVIRONMENTAL® D2CX20-21 SERIES Submersible Centrifugal Grinder Pump

The Changing Force in Pressure Sewer

The reliable D2CX20-21 2 hp submersible centrifugal grinder pump offering by Delta Environmental is especially designed for use in low pressure sewer systems with long discharge runs or high static heads. The D2CX20-21 grinder pump features an innovative hardened cutter mechanism and recessed impeller design to effectively macerate typical domestic sewage solids into a fine slurry and is listed UL for hazardous location construction for use in Class 1, Group D hazardous locations. As the world evolves from concrete septic tanks and large piping gravity collection systems to more innovative wastewater solutions, the use of submersible grinder pumps in Low Pressure Sewer (LPS) systems for the residential developer applications has proven to be a superior solution that is cost effective and minimally disruptive to the natural environment. For additional information, please contact your local Delta Environmental representative.

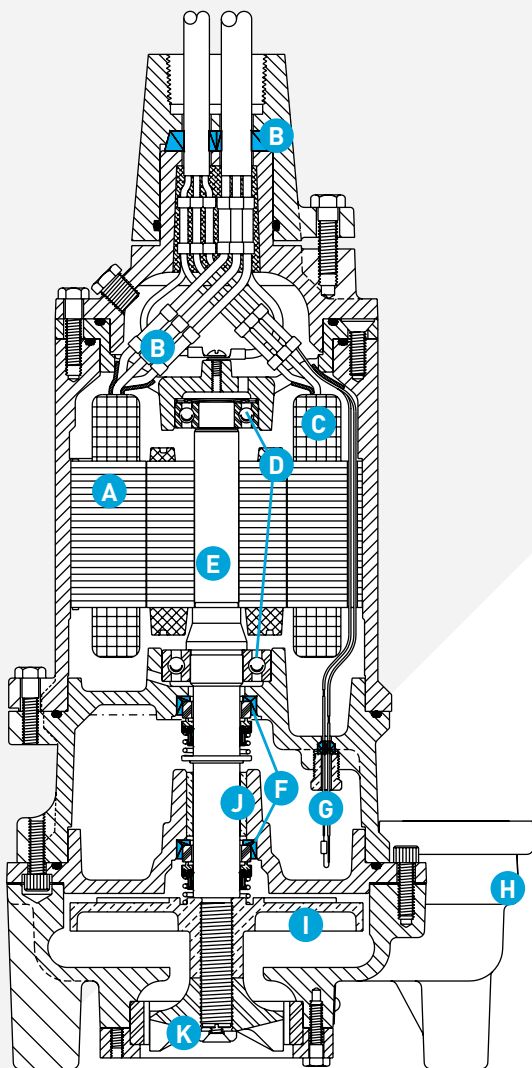

A. Powerful Motor

2 hp, 3450 rpm, 230 volt, 1 phase.
Press fit for perfect alignment and best heat transfer. Oil-filled motor conducts heat and lubricates bearings.

B. Cable Entry System

Provides double seal protection. Cable jacket sealed by compression fitting. Individual wires sealed by epoxy potting.

C. Heat Sensor

Protects motor from burn-out due to excessive heat from any overload condition. Automatically resets when motor has cooled.

D. Ball Bearings

Upper and lower ball bearings support shaft and rotor and take axial and radial loads.

E. Heavy 416 SST Shaft

Corrosion resistant. Reduces shaft deflection due to grinding loads.

F. Shaft Seals

Double tandem mechanical shaft seals protect motor. Oil-filled seal chamber provides continuous lubrication.

G. Seal Leak Probe

Detects water in seal housing, activates warning light in control panel.

H. Volute Case

Cast iron 1¼" NPT vertical discharge.

I. Impeller

Bronze recessed impeller handles ground slurry without clogging or binding. Provides unobstructed flow passage. Reduces radial loads. Pump-out vanes help keep trash from seal, reduces pressure at seal faces.

J. Sleeve Bearing

Takes radial load; provides flame path.

K. Grinder Assembly

Grinder impeller and shredding ring are replaceable without dismantling pump. Constructed of 440 SST hardened to 56 – 60 Rockwell.

Pump Details

Pump Performance

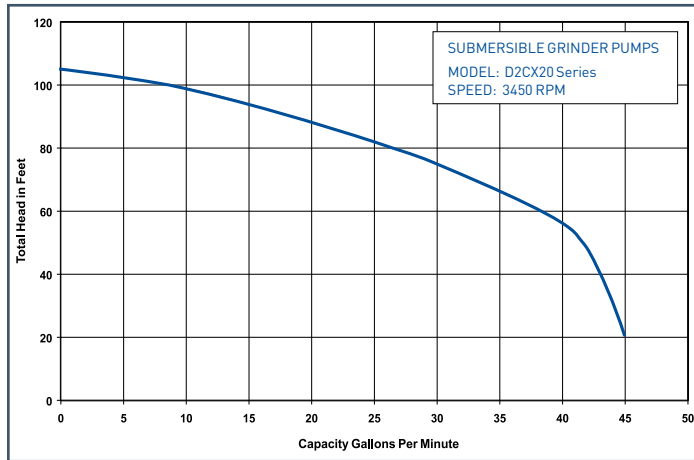

Pump Dimensions

(Dimensions in MM)

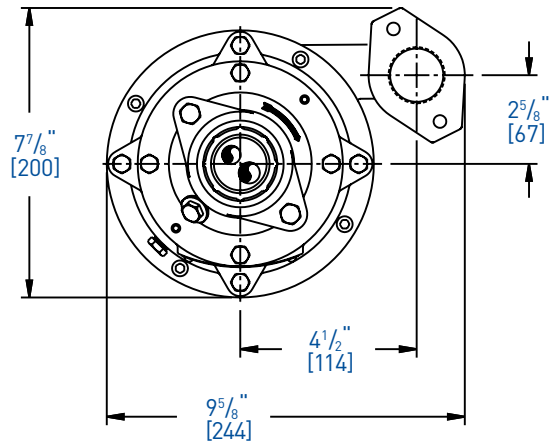

Pump Capabilities

Liquids Handling	Domestic raw sewage	
Intermittent Liquid Temp.	Up to 140° F	Up to 60° C
Winding Insulation Temp. (Class F)	311°F	155°C
Motor Electrical Data	2 hp, 3450 RPM, 1 ph - capacitor start/run. 230V, 60 Hz	
Third Party Approvals	CSA, UL	
Acceptable pH Range	6 - 9	
Specific Gravity	.9 - 1.1	
Viscosity	28 - 35 SSU	
Discharge, NPT	1-1/4 in.	31.75 mm

Note: Consult factory for applications outside of these recommendations.

Construction Materials

Motor Housing, Seal Housing, Cord Cap, Volute Case	Cast iron, Class 30, ASTM A48	
Impeller	Recessed, bronze	
Power Cord	15 ft. 14/4 SOOW	
Control Cord	15 ft. 18/5 SOOW	
Mechanical Seals -	Std.	Dbl. tandem carbon & ceramic
	Opt.	Lower tungsten carbide
Pump, Motor Shaft	416 SST	
Fasteners	300 Series SST	
Shredding Ring, Grinder Impeller	440 SST, 58-60 Rockwell	

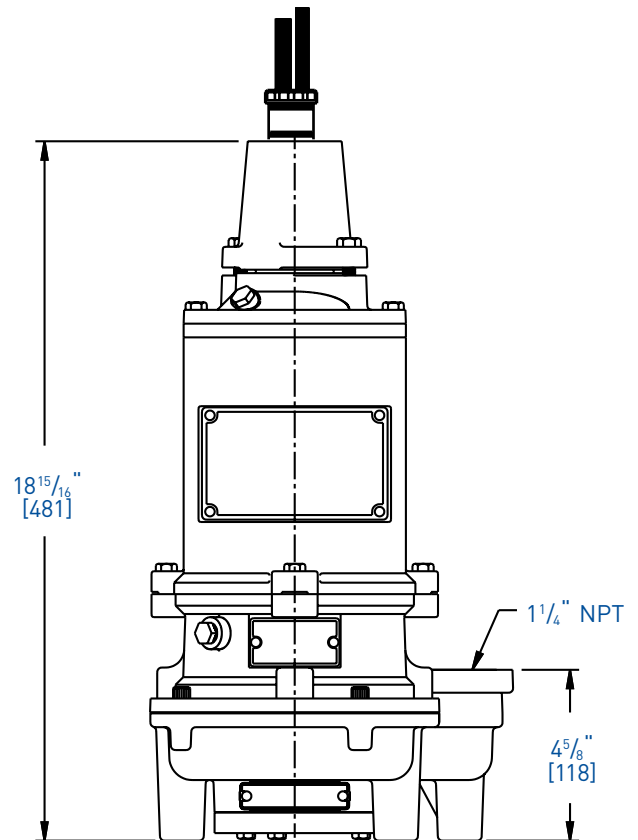

Available Models	Motor Electrical Data										
Hazardous Location	HP	Volts	Phase	Hertz	Start Amps	Run Amps	Run kW	Start KVA	Run KVA	Code Letter	NEC Service Factor
D2CX20-21	2	230	1	60	44.0	12.0	2.8	10.1	2.8	F	1.25

Installation Details

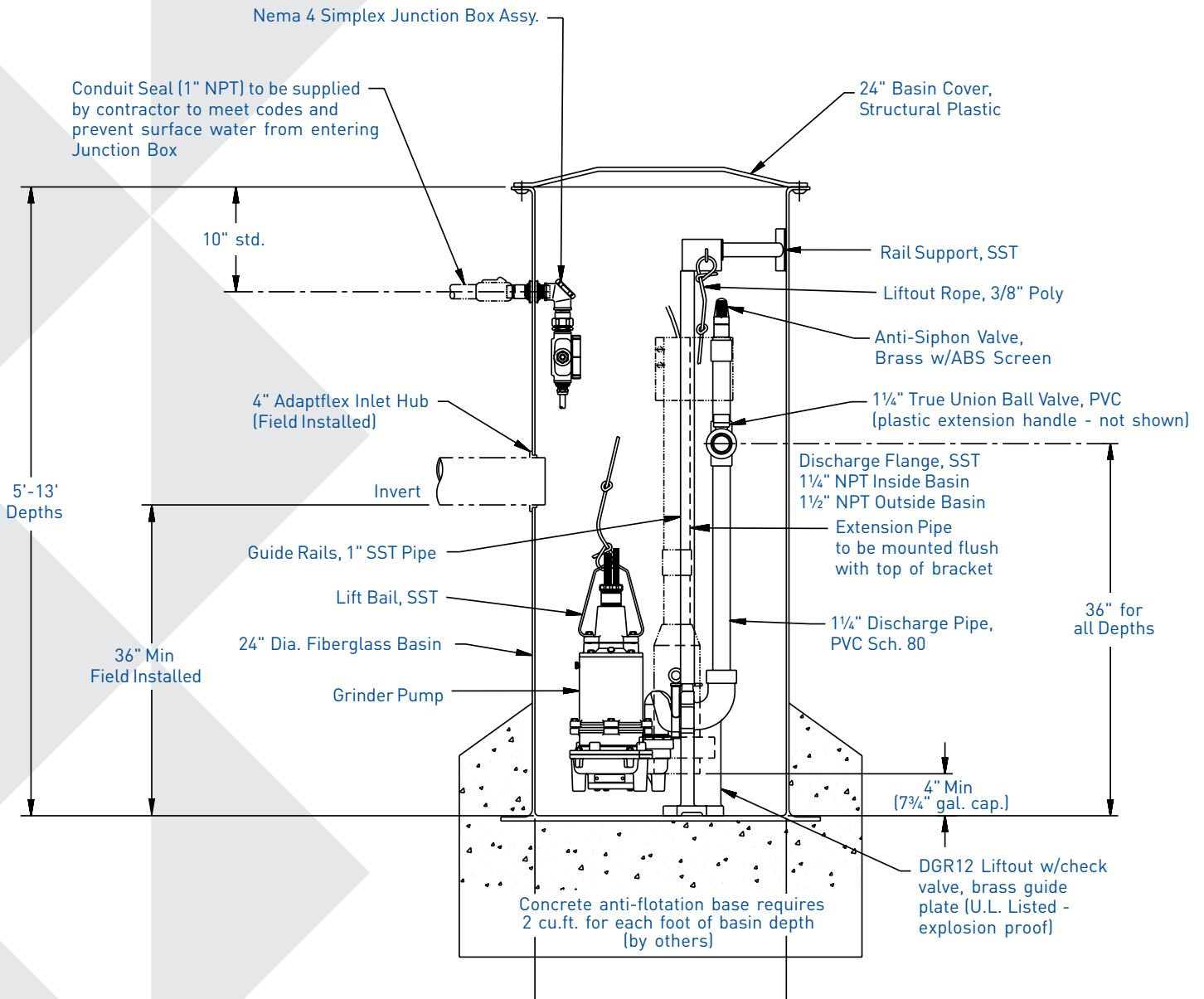

8263 FLORIDA BLVD., DENHAM SPRINGS, LA 70727, 225-665-6162, 1 (800) 219-9183 | WWW.DELTAENVIRONMENTAL.COM

Because we are continuously improving our products and services, Pentair reserves the right to change specifications without prior notice.
K4266 07/28/13 © 2013 Pentair Ltd. All Rights Reserved.